

# Visita

Inside this issue

Dates announced for LI infrastructure conference

In profile: BM3 Architecture

Conduct corner: legal duty of care

LI welcomes seventy new chartered members

## Goodbye but not farewell from the Capability Brown Festival



The Capability Brown Festival 2016 has come to a close, although interest in the man and his work continues to flourish. The Festival raised the profile of historic designed landscapes, encouraging visitors, owners and managers of Brown sites to consider their landscape as so much more than a lovely view to frame the house, or the 'green bit' between the house and car park. The Festival emphasised the fact that the landscapes are as manmade as the houses that sit within them, and that they were shaped with much more than beauty at their core. One of the few extant quotes from the man himself describes his approach as 'hiding what is disagreeable and shewing what is beautiful'.

As the first ever celebration of Brown's work, the Festival aimed to introduce new and larger audiences to Brown and to historic landscape design. This meant visitors as well as project participants, readers, viewers, researchers and students.

Our main aim was to uncover new knowledge about Brown and his work and make it easily accessible and engaging to a broad audience, while building relationships between people and organisations with a shared interest in Brown and the

historic landscape. Luckily, the media found Mr Brown and his work rather intriguing and the Festival received broad and ongoing coverage, including 86 TV and radio pieces, with an international audience topping out at approximately 4.7 billion. Royal Mail released a set of stamps to commemorate Brown in the probable month of his birth, and nearly 500 events and over 60 exhibitions celebrating his work and historic landscapes took place all over the country. Many have extended their run into 2017 as interest continues.

At the time of writing, we are still collating the figures from all the sites that were commissioned to deliver part of the festival. Overall, visitor numbers to Brown sites – and in particular their historic landscapes – do seem to have gone up. We hope that this will encourage the sites' custodians to think more about interpreting their landscapes in future years.

The LI will be keeping the Festival website live at [www.capabilitybrown.org](http://www.capabilitybrown.org), and we will soon be posting the culmination of the three years of research as a set of leaflets, maps and webpages with in-depth information on individual Brown landscapes. An executive summary of the Capability Brown Festival's report to our key funder, the Heritage Lottery Fund, will be published online later in the year.



Chatsworth's landscape from a 21st Century perspective



Community group from Sheffield exploring Chatsworth and its kitchen garden

## LI infrastructure conference to take place in Manchester on 22–23 June

The way in which landscape is infrastructure in its own right, as well as the need to rethink conventional infrastructures as landscapes, will be at the heart of the LI's annual conference at Manchester Metropolitan University (MMU). Delivered in partnership with the LI North West

Branch, MMU and University of Manchester, the conference will take place on 22 and 23 June 2017.

Day one of the conference will include structured sessions for all delegates, while day two will include a variety of CPD-approved seminars, discussions, and guided site visits in

and around Manchester and Salford City Centres.

This is the first year that the LI has called for members and colleagues to propose ideas for conference sessions, and we were delighted to receive so many excellent submissions around themes including health

and wellbeing, parks, and water management. We would like to thank everyone who took the time to enter papers and proposals. The LI's conference working group is in the process of responding to members who submitted material, and a full timetable will be announced in due course.

Booking information will be published on the LI website, [www.landscapeinstitute.org](http://www.landscapeinstitute.org), in the coming days. Be sure to visit us or follow us on Twitter @talklandscape for the latest details.

# Stand for election to the LI Board and Council and enjoy a deeper connection with the LI and your profession

## Positions available on Board and Council to elected members

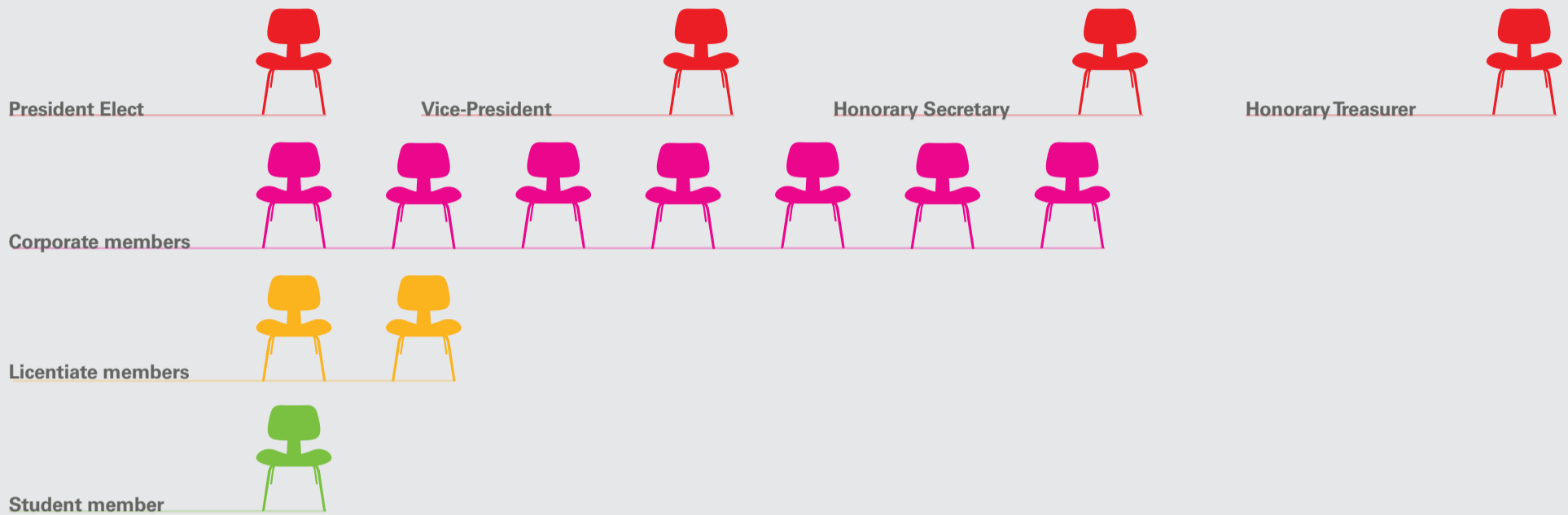

The Advisory Council is the backbone of the LI. Bringing together members from all over the UK, and from the many diverse landscape disciplines – from design to science, planning to management – it sets the agenda for how the LI represents and serves its members and inspires support for the landscape profession.

Council members meet three times a year to discuss the LI's strategic direction, governance and professional oversight, and policy

and technical standards. The most recent meeting saw members meet and collaborate with practices, non-government organisations and other bodies to gain valuable insight and help ensure the profession's continued relevance and success.

Elections to the Council and Board of Trustees take place every two years. The next elections will run throughout the whole of May, with newly elected members taking office on 1 July. All corporate members are entitled to vote in Council and Board elections,

which this year includes academic members, academic fellows and licentiates.

### What positions are available?

Serving on the Board or Council can enliven your career, enhance your knowledge and help you forge a deeper connection with your profession.

14 Council positions are directly elected: 10 Council Members, and four elected Officers who take positions on both the Council and Board. There is also a new

position available on the Board for a non-chartered trustee. The remainder of the Council comprises representatives from the LI's 12 branches and its three standing committees, who are elected or appointed separately.

### How do I stand for election?

Nominations for the May elections open on 14 March. At this time, all members will receive an email directing them to the elections website, where nominations can be made online. The website will

also include relevant documents such as job descriptions and terms of reference. General governance documents can be found by logging in to the Member Lounge at the LI members' website: [members.landscapeinstitute.org](http://members.landscapeinstitute.org). Nominations will close on 14 April.

For more information on the elections or to find out more about what is involved in sitting on the LI board or council, contact Head of Finance and Governance Andy Wallace on [andy.wallace@landscapeinstitute.org](mailto:andy.wallace@landscapeinstitute.org).



### Adrian Clarke

Branch Representative, North East  
*"I have really enjoyed my time on Advisory Council over the last four years. It has given me a great level of insight into the work of the Institute, and the dedication of the staff and volunteers who make it all possible. Branch representatives have a very important role in that they are a conduit for information and exchange between the Institute and its members. It has been an honour to serve in this role and I feel privileged to have met so many great people, who have become friends over the years. I am sad to be finishing my term, but will continue to be involved in the North East branch and hope to stay in touch with all my colleagues on Council."*



### Rachel Tennant

Branch Representative, Scotland  
*"The opportunity for me to attend the Advisory Council meetings as Scottish Branch Rep has emphasised for me how important a role members play in shaping the direction of the profession through influencing and contributing to the good work of the Landscape Institute. Not only was I able to contribute to key Council debates to ensure the voice of the membership is heard, I was also able to discuss issues that affect other branches and help to find shared solutions. Collaborating in this way is a very rewarding experience."*



### David Watkiss

Branch Representative, Northern Ireland  
*"I joined the Advisory Council in 2013, where I was fortunate to witness first-hand the important work the Advisory Council and Board undertake on behalf of the membership. Working with landscape architects from all over the United Kingdom and meeting people from many different backgrounds and at different stages of their own career path was stimulating, as was feeding into the debate with supporting comments from the area branches. Playing an active role in the Council discussions was a rewarding experience, which reignited my passion for the profession as a whole."*



### Sue Illman

Past President of the Landscape Institute  
*"I would recommend that anyone who has a keen interest in the future of our profession considers standing for Board or Council. Shaping how we operate in an uncertain future is an ongoing challenge, and it's essential to have a wide range of views. We particularly need fresh input from younger members who will lead the profession in the future, and from those who over time may wish to become President – a role that has allowed us to advance a very diverse message around landscape in recent years. Serving is a great honour, and I hope others want to step up to the plate."*

“We need input from members who will shape the future of the profession”

# In profile: BM3 Architecture



© BM3 Architecture

Left to right: Katie Allen, Ross Pritchard, Matthew Honey

BM3 is a traditional architecture studio based in the creative quarter in Digbeth, Birmingham. BM3 has quietly built a reputation on delivering high-quality, innovative architecture, generally covering the South East to North West along the M1, M25, M6 and M5 corridors. The majority of BM3's projects are based in a residential setting, with public space, education, leisure and extra care schemes forming an increasing part of the day-to-day working.

The practice diversified into landscape architecture in 2014, bringing in Ross Pritchard CMLI to head the new team. They now have a core team of three and a shared technical resource with the architectural team. One of the key advantages to being 'in-house' with the architects is the collaborative approach to masterplanning, with core landscape, ecology and urban design objectives addressed upfront at feasibility stage to form principles

that unify schemes with the surrounding landscapes.

A prime example of this is BM3's scheme with Keepmoat in Wellingborough: a town centre mews development just behind the

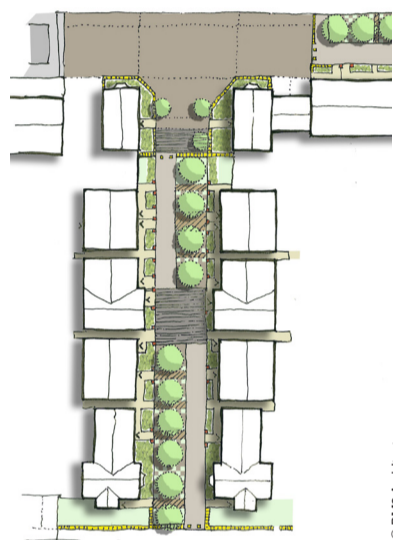

The pedestrian link at High street, Wellingborough (plan)

© BM3 Architecture

high street. The design sought to create a high-quality public realm that would link the mews back to the high street with a series of interconnecting transitional spaces. It was important that the access for pedestrians and cyclists was maintained while curtailing car traffic. Key cycle and pedestrian routes were designed with a courtyard appearance. Dwellings look out over soft planted frontages: cornus kousa trees and chequerboard lawns of paviers and creeping thyme.

Because of the scheme's town centre location, there were restrictions on space for sustainable drainage systems (SuDS). BM3 utilised rain gardens to ensure that adequate storage was supplied, while also using the space to green the streets.

As well as new developments, BM3 does a lot of work in estate regeneration and refurbishment. The practice is currently working to deliver environmental enhancements to a 380-unit Radburn estate at Manor Farm, Coventry. The estate has fallen into disrepair over the past 50 years and is now undergoing renewal. Local user groups and residents were engaged to develop a series of principles for enhancing access, creating courtyard spaces and improving parking. The layout of the parking formerly revolved around garage courts, which were replaced with a more contemporary 'Woonerf' style carriageway and parking to slow the traffic and create greener entrance spaces. The scheme comprises £2.1 million external works improvements.

Being a social practice, BM3 gets involved with local arts projects. In summer 2015 the practice created a temporary pavilion called 'Urban Labyrinth', which housed an exhibition

exploring the changing face of Birmingham through photography and sound. The purpose-built exhibition, constructed entirely from recycled palettes sourced from the local area, was part of RIBA's 2015 'Love Architecture' festival, which celebrated architecture and the built environment during the summer months.

This year, BM3 will be working on a courtyard garden to replace the 'Urban Labyrinth'. You can follow the progress of the project on their Twitter page, @BM3Architecture.

**Location:** Digbeth, Birmingham and Islington, London

**Founded:** 1989

**Employees:** 60



The pedestrian link at High street, Wellingborough (render)

© BM3 Architecture



BM3 team members in the Urban Labyrinth

© BM3 Architecture

## Movers and makers: updates from the landscape sector

A list of recent developments publicised by LI Registered Practices.

**Andrew Harland has been appointed chairman of LDA Design**, assuming the post from Professor Robert Tregay, senior partner and chairman for the past 20 years. Andrew, who has been with LDA for over 30 years, is an urban landscape architect specialising in mixed-use high-density development, the design of new parks and the regeneration of rundown green spaces.

**The tidal power lagoon in Swansea Bay** has been given the go-ahead following a recommendation from an independent government review. LDA Design are working with Tidal Lagoon Power as master planners and lead designers for the project, and also consultants for the proposed lagoon fleet. Swansea Bay Tidal Lagoon will be a pathfinder for a further five plants in the UK and will ultimately provide approximately a tenth of the UK's electricity needs.

**LUC** celebrated two promotions in 2016. Seb West became Senior Landscape Manager, while Matthew Parkhill was promoted to

Associate. The team also welcomed Inez Williams, a new recruit with a background in landscape management and heritage.

**PLACE Design + Planning and Bell Fischer Landscape Architects (BFLA)**, two award-winning London-based landscape architecture practices, announced their amalgamation in November. The combined practice of 14 staff will initially operate from the two existing offices, but BFLA staff will join PLACE's office in Wimbledon later this year.

**Gillespies' Landscape Design** in London has recently been joined by new associates Kyle Morrison and Justin Morey CMLI. Kyle Morrison joins from Gensler Associates and will play an active role in leading and developing Gillespies' Middle Eastern portfolio. Justin Morey, specialising in large-scale town centre regeneration and urban public realms, will be leading a wide range of public realm projects across the UK and internationally.

**Gillepsies' Manchester team** has also expanded with the

recruitment of three new staff. Rebekah Russell joins as an urban designer from Pegasus with an in-depth knowledge of the residential sector; Zac Ford arrives from Wardell Armstrong as a landscape architect with wide-ranging infrastructure and landscape planning experience; and Sam Hamilton is a landscape graduate from Manchester Metropolitan University.

**Gustafson Porter** has become Gustafson Porter + Bowman from January 2017 to reflect the evolving nature of the growing practice and the pivotal role played by Mary Bowman. The innovative landscape architecture practice, known for its sensual and sculptural features, was established in 1997, and the 34-strong team is currently working on high-profile projects in the UK and overseas.

*Would you like to publicise any changes in your practice that may be of interest to fellow members?*

*Get in touch with the editor at [ben.gosling@landscapeinstitute.org](mailto:ben.gosling@landscapeinstitute.org)*

## Conduct Corner

Important conduct-related updates and issues related to best professional practice.

### CPD monitoring for 2016 is now under way

The LI began its current CPD monitoring period, covering the CPD undertaken by members throughout 2016, in January. Each year, 3% of corporate members are selected at random and asked to submit their CPD record for review.

CPD is a structured process of learning and reflection that helps individuals look ahead to their own development requirements, often in line with their appraisals and professional ambitions. Contact Education Development Officer Poppy Smith at [cpd@landscapeinstitute.org](mailto:cpd@landscapeinstitute.org) to find out about the various ways in which the LI supports members with their professional development.

### 'Mates' rates' and the duty of care

While the parameters of most jobs are agreed at the outset, every now and again a landscape professional may give informal advice to a friend, or do a job at a reduced rate. It is important to treat these instances like any other job and make sure a written contract is in place.

'A legal duty of care can arise whenever a practitioner uses their professional skill,' warns Chris Rowse, Senior Associate at Russell-Cooke Solicitors. 'This is true even if there is no written contract or payment.'

Where there is a duty of care, there is the possibility of a claim for professional negligence – even in the case of informal jobs. According to Martin Jackson, Director at insurance broker McParland Finn Ltd, claims can arise from copyright, design, ecology, fee disputes, planning, and specification issues, with design and specification being particularly common in recent years.

'There's always a risk that things may go wrong, and it's worth making sure that you're protected', continues Chris. 'The courts have found that it doesn't take much more than an informal conversation for a duty of care to arise.'

'If you decide to go ahead it's best to have a written contract in place, even for a small job. It gives both parties clarity in relation to what work is being done and who is responsible for what.'

# LI welcomes seventy new chartered members



Clare Brockhurst FLI recounts her own career journey

with her professional skills. 'Achieving chartered status is a great feeling, which gives you renewed confidence and belief in your skills as a landscape architect', she said. 'I am looking forward to taking the lead in projects at [my employing practice] Connon Design Landscape Architects and being more involved in the business as a whole.'

#### Full list of graduates

Maya Abdul-Latif, Ana Abram, Lulu Almana, Imran Ashiq, Keith Baker, Richard Brown, Matthew Cairns, Neil Campbell, Michelle Catlow, Wen-Chih Chao, Joseph Clancy, Patrick Clark, Ryan Coghlan, Enda Coughlan, Anne Dally, Marie Davis, Elizabeth Duberley, William Dutch, Jenny Elliott, Mark Evans, Lisa Finch, Robyn Friesner, Alexandra Gardiner, Tom Green, Nicola Greenwood, Daniel Haigh, Rui He Hyland, Zebulon Hoffman, Chris Hughes, William Johnson, Sanna Jonsson Buttery, Kirsty Knott, Eleanor Larke, Zsuzsanna Lieber, Rowan Longhurst, Laura Mackie, Peter McDonald, Jamie Metcalfe, Malgorzata Mikos-Opyd, James Morton, Di Murphy, Jennifer Neal, Suzanne O'Connell, Leighton Pace, James Parker, Sophie Parker-Loftus, Charlie Pierson, Robert Playford, Michael Samuels, Deepa Satagopan, Jon Seymour, Maciej Skiba, Andrew Smith, Tracy Smith, Maria Stefanidou, Bethan Thomas, Christina Todd, Nick Tolley, Amelia Tollitt, Scarlett Towse, Naomh Turbett, Stuart Walker, Lin Wang, Laura Welborn-Baker, Nicola Whiting, Callum Whyte, David Wilkinson, Gavin Woolston, Ka Man (Nicole) Yip, Michal Zarzecki

Following presentation of the certificates, Merrick took to the stage a second time to pay thanks to the speakers, congratulate the graduates once again, and to echo Dan Cook's sentiments that the LI is there to support them.

"It's in your hands," he said, referring not just to the Institute, but also the future of the landscape profession – and perhaps the future in general.

along my pathway, and I hope to be able to pass on what I have learned to others going through this process in the future.'

Deepa Satagopan said: 'I cannot begin to express how incredibly fulfilling this journey has been for me both personally and professionally. It was hard managing a family with two children and studying at the same time but with the help of a supportive husband, wonderful mentor, colleagues and friends, I was able to focus and get the most from the process. I have always felt responsible for work that I produce, but I feel even more responsible now. I look forward to adding value to this profession and one day mentoring others on the Pathway.'

For Sophie Parker-Loftus, the evening was a celebration of a community, as well as individual accomplishments. 'It was so wonderful to come together to celebrate our achievements at the graduation ceremony,' she said. 'It was fabulous to meet and share views with so many people in our discipline who are passionate about their work. I look forward to being part of an exciting profession designing and shaping spaces for future generations to come.'

Naomh Turbett felt that the Pathway helped reconnect her

On Thursday 26 January, the LI welcomed 70 new chartered members at a graduation ceremony held at the Institute of Education, London.

'Welcome to our exciting profession,' began LI President Merrick-Denton Thompson. In a stirring speech, he emphasised that landscape is about more than designing and making places; natural capital, health and wellbeing, resilience and more are all on the agenda, and the work that members do will be important for hundreds of years to come.

Graduates also heard from Dan Cook, the LI's new CEO, and Clare Brockhurst FLI, founding partner of Tyler Grange and a Pathway to Chartership mentor. Clare gave a passionate and inspiring account of her own career journey, urging graduates to be bold, love what they do and remember why they wanted to be landscape professionals in the first place. She called on graduates to 'embrace the diversity of the landscape profession', noting that different landscapes underpin our need for design, planning and management: 'there isn't a single solution.'

The main message of the evening was that a career in landscape is rewarding not just for the professional, but for the generations of people that will make use of their work. Indeed, the talks were so inspiring that they roused some of the non-members present!

'My guest isn't in the landscape profession but, due to the passionate and inspiring speeches, was seriously considering it by the end of the evening!' said recent graduate Bethan Thomas. 'I would like to thank the Institute for the lovely evening we had to celebrate our achievements, as well as the speakers.'

Some members are already considering becoming Pathway to Chartership mentors themselves. Bethan continued: 'I really appreciated the guidance I was given

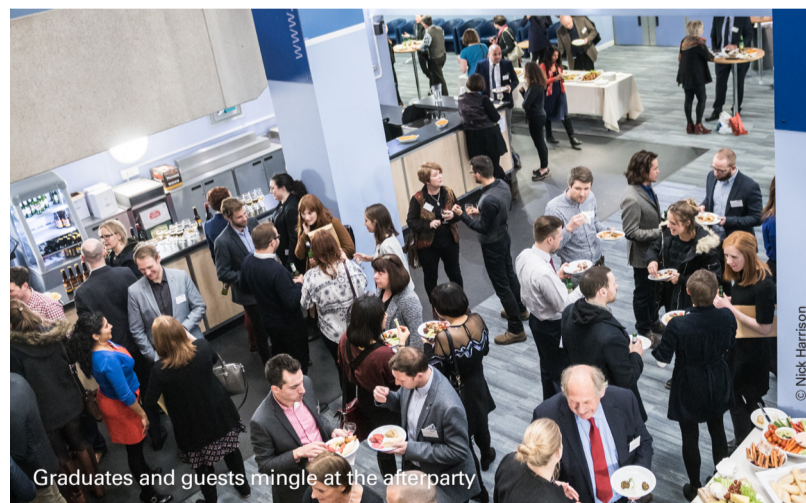

Graduates and guests mingle at the afterparty

# Keeping up with technical developments

As landscape professionals, how do we keep up with everything that's happening? We sense that there are constant technical developments, but it is difficult to keep up with the day job, let alone remember what we learnt the previous year.

#### Tools and resources that can help

Tools such as Tweetymail will email you digests of new tweets that include particular keywords. Google Alerts will do a similar job of monitoring new additions to the web, while Change Detection can advise you of changes to existing webpages.

Resources to find relevant events include Meetup and Eventbrite. To be notified of useful scientific publications, create an account at Science Direct, conduct a suitable search and then elect to receive email digests of new publications.

The Landscape Institute does all this and also tweets relevant findings from a wide range of events and journals. If you wish to remain abreast of technical developments, it pays to follow @talklandscape



You can contact your colleagues about an astonishing range of subjects



and @LI\_SimonO. (Keep an eye out for the hashtag #LITech.)

Above all, we are a community who can help one another. If you keep up-to-date information on your expertise in your members' area on the LI members website, you will know that you have colleagues who are willing to be contacted about an astonishing range of subjects. You can find and contact members using the member directory on the LI members' website, or by signing into the Talking Landscape member network.

## Let us help you.



We are dedicated to helping members of the Landscape Institute and their families, in times of need.

### We provide:

- Advice
- Support
- Financial help
- Referral for specialist advice

In urgent cases we can give assistance immediately.

**Please contact us today.**

**020 7580 2823**

**help@absnet.org.uk**



@ArchBenSoc

www.absnet.org.uk

43 Portland Place, London W1B 1QH . Registered Charity No: 265139

Vista is a quarterly publication covering areas of particular interest to Landscape Institute members. For more detail on the topics raised, visit the Landscape Institute website.

Vista is available online and includes links to relevant website sections.

If you have an idea for an article or promotional piece, do get in touch by contacting the editor, Ben Gosling: Ben.Gosling@landscapeinstitute.org

To comment on any aspect of LI communications please contact Paul Lincoln, Deputy Chief Executive: PaulL@landscapeinstitute.org

Join the discussion on Talking Landscape: talkinglandscape.org

Visit our website: Landscapeinstitute.org | Visit our careers website: Bealandscapearchitect.com

Follow us on twitter: @talklandscape | Visit The Parks Alliance: theparksalliance.org

Visit the Capability Brown Festival: capabilitybrown.org

© 2017 Landscape Institute | 107 Gray's Inn Road, London, WC1X 8TZ

## Landscape Institute

Inspiring great places

The Landscape Institute is the chartered body for the landscape profession. It is an educational charity working to promote the art and science of landscape practice.

The LI's aim, through the work of its members, is to protect, conserve and enhance the natural and built environment for the public benefit.

The Landscape Institute provides a professional home for all landscape practitioners including landscape scientists, landscape planners, landscape architects, landscape managers and urban designers.

Editor Ben Gosling  
Design darkhorsedesign.co.uk

Vista is printed on FSC paper obtained from a sustainable and well managed source, using environmentally friendly vegetable oil based ink.

The views expressed in Vista are those of the contributors and not necessarily those of the Landscape Institute, Darkhorse Design or the Editor. While every effort has been made to check the accuracy and validity of the information given in this publication, the Institute, Darkhorse Design or the Editor accept no responsibility for the subsequent use of this information, for any errors or omissions that it may contain, or for any misunderstandings arising from it.